

## WHERE WE ARE IN THE EA PROCESS

The EA process began with alternative concepts for the landfill (such as landfill footprints, leachate treatment methods and haul route locations.) The focus now is to assess the possible environmental impacts of the proposed expansion, and how they should be prevented or managed.

The figure below outlines the 13 steps in the EA process and shows the relationship of each discussion paper to the steps in the EA. Please note that Discussion Paper #1 on the proposed consultation process applies to the whole EA process, not any single step.

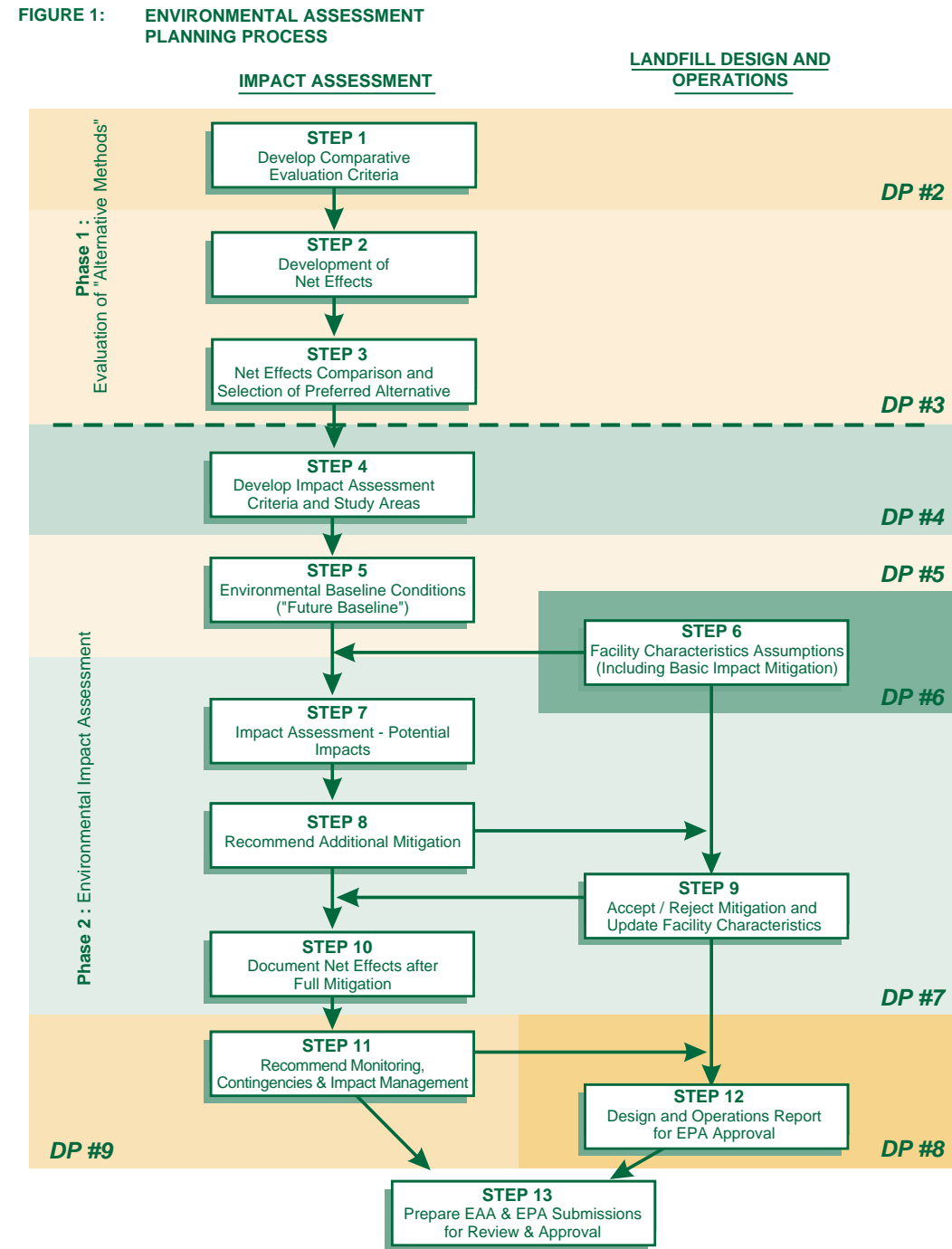

STATUS OF DISCUSSION PAPERS	
<b>Discussion Paper #1:</b> Proposed Public Consultation Program	Finalized
<b>Discussion Paper #2:</b> Proposed Criteria and Indicators for the Assessment of Alternatives	Finalized
<b>Discussion Paper #3:</b> Comparative Evaluation of Alternatives - The Preferred Alternative	Public Review Period - Comments requested by February 28, 2002
<b>Discussion Paper #4:</b> Impact Assessment Process	Public Review Period - Comments requested by February 8, 2002

You may obtain copies of the discussion papers at the Township of Warwick Municipal Office, the Watford Library and the Warwick Landfill Office or call 1-800-555-3561 to have a copy sent to you.

## FINAL DISCUSSION PAPER #2 NOW ISSUED

Final Discussion Paper #2: Proposed Criteria and Indicators for the Assessment of Alternatives is now available. All comments from peer reviewers, government agencies, the EASG and public are included, with CWS responses.

## WHO TO CONTACT...

If you would like more information on the proposed expansion, please call the toll-free Warwick landfill information line at 1-800-555-3561 or for additional information or to discuss the public consultation program, please contact:

**Peter Homenuk**  
IER Planning, Research and Management Services  
7501 Keele St., Suite 300  
Concord, ON L4K 1Y2  
Fax: (905) 660-7812  
E-mail: phomenuk@dpra.com

To discuss CWS' proposed landfill expansion, you may also wish to contact:

**Kevin Bechard**  
Divisional Vice-President  
Facility Development  
Canadian Waste Services  
3525 Mavis Road  
Mississauga, ON L5C 1T7  
Phone: (905) 615-8800 Ext. 23  
Fax: (905) 615-1113  
E-mail: kbechard@wm.com

If you have questions or comments on the day-to-day operations of the Warwick landfill site, contact:

**Reid Cleland**  
Landfill Manager  
Warwick Landfill  
8039 Zion Line, R.R. #4,  
Watford, ON N0M 2S0  
Phone: (519) 849-5810  
Fax: (519) 849-5811  
E-mail: rcleland@wm.com

## Proposed Warwick Landfill Expansion Environmental Assessment Study Group Meeting #7

**Date:** Monday, February 18, 2002

**Time:** 7:00 to 9:00 p.m.

**Place:** Lambton Mutual Insurance Company

For more information, call the toll-free Warwick Landfill Information Line at 1-800-555-3561

# WARWICK LANDFILL EXPANSION THE ENVIRONMENTAL ASSESSMENT PROCESS

## SITE ALTERNATIVES WORKSHOP

At a workshop on November 29, 2001, twenty-one Warwick and Watford residents (landfill neighbours and other interested persons) spent an evening providing their views on criteria and indicators to be used for deciding among the alternative landfill footprints, leachate treatment methods and alternative haul routes. At this workshop participants rated Public Health and Safety as the most important criteria group and Social and Cultural as the least important. Natural Environment and Economic criteria groups were rated in between.

Following the workshop, each of the alternatives for landfill footprints, leachate treatment and haul routes were compared according to the specified criteria and indicators. Then the preferred alternatives were identified with consideration of the values expressed at the workshop.

## LEACHATE TREATMENT AND TRUCK HAUL ROUTE ALTERNATIVES

The 'preferred alternatives' are the alternatives with the fewest anticipated adverse impacts based on the criteria and indicators. The impacts of these alternatives will now be examined in detail. If the impacts associated with a preferred alternative are determined to be unacceptable or an alternative is not technically feasible, CWS will have to re-examine the alternative under consideration.

### The preferred leachate treatment methods are:

- on-site pre-treatment with discharge via forcemain to the Watford Treatment Plant;
- and
- on-site full treatment with effluent discharge to the atmosphere or nearby surface water bodies.

**Highway 79/Zion Line is the preferred truck haul route to the site.**

**The West landfill footprint has been selected as the preferred alternative.**

CWS has described the analysis and results of the evaluation of site alternatives in draft Discussion Paper #3: Preferred Alternatives. See Page 2 for a summary of the results. Draft Discussion Paper #3 is now available for public review.

You may obtain a copy of Draft Discussion Paper #3 at:

- The Township of Warwick Municipal Office
- The Watford Library
- The Warwick Landfill Office

Or call 1-800-555-3561 to have a copy sent to you.

Comments on Draft Discussion Paper #3 are to be provided to IER Planning, Research and Management Services by February 18, 2002

## IMPACT ASSESSMENT PROCESS DESCRIBED IN DRAFT DISCUSSION PAPER #4

Draft Discussion Paper #4 describes how the potential environmental impacts of the proposed expansion will be assessed. This includes:

- Key definitions of terms used in the assessments.
- The study areas and criteria for each discipline.
- A step-by-step description of the work to complete the baseline (existing) conditions and the effects assessment
- A list of the consultants by discipline who will be doing the impact assessments.
- A list of regulations, Guidelines or Source Material

See Page 3 for more information on Draft Discussion Paper #4.



## WHAT'S INSIDE...

### PAGE 2 and PAGE 3 RESULTS OF THE EVALUATION

The Landfill Footprints  
Leachate Treatment  
Truck Haul Routes

### DRAFT DISCUSSION PAPER #4 - IMPACT ASSESSMENT PROCESS

The CWS Consulting Team  
Changes to the Consultation Program  
Final Discussion Paper #2

### PAGE 4

Where we are in the EA Process  
Who to Contact

The environmental assessment (EA) for the proposed Warwick landfill expansion is continuing. As Canadian Waste Services (CWS) proceeds with the studies, it has committed to keep local municipalities, the public, community interest groups and government agencies informed throughout the EA. This is the third in a series of newsletters that CWS will distribute as the EA process continues. To receive the earlier EA newsletters, or those distributed during the development of the Terms of Reference, please call the toll-free Warwick landfill information line at 1-800-555-3561.

## RESULTS OF THE EVALUATION

### THE LANDFILL FOOTPRINTS

The preferred landfill footprint is the West Footprint.

#### The Reasons:

- Larger separation from the Watford Settlement area including residents and facilities.
- Smaller footprint area.

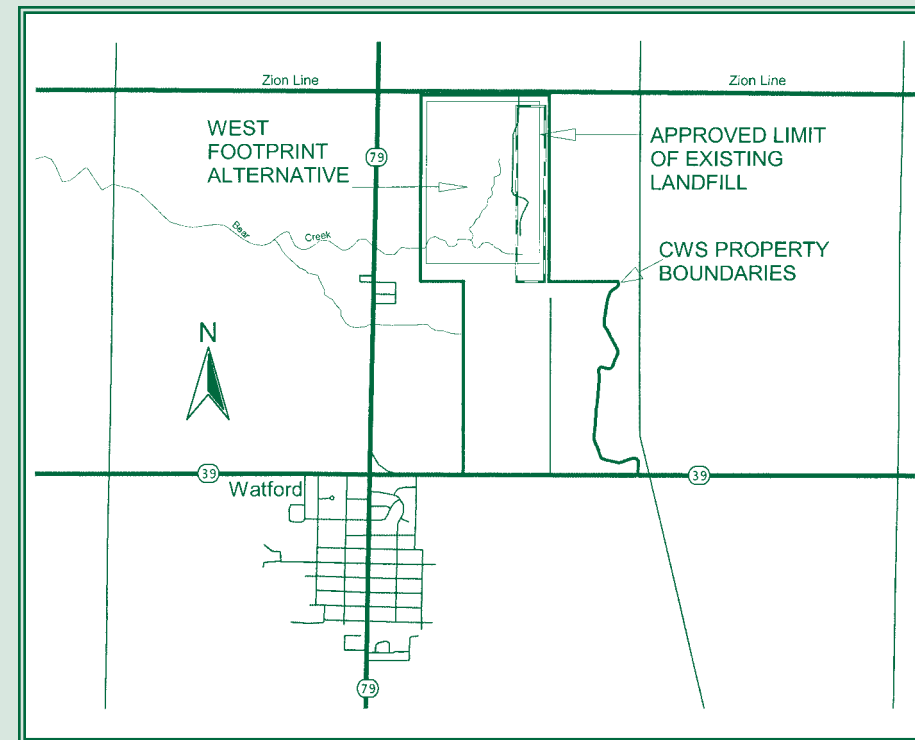

### LEACHATE TREATMENT

The preferred methods for leachate treatment are:

- Full on-site treatment with discharge to air or surface water; and
- On-site pre-treatment with discharge via forcemain to Watford Sewage Treatment Plant (Subject to Township of Warwick approval).

#### The Reasons:

- No additional truck haulage for leachate.
- Watford Sewage Treatment Plant would be upgraded.

### TRUCK HAUL ROUTES

The existing haul route from Highway 79 east along Zion Line is the preferred alternative.

#### The Reasons:

- This haul route already exists.
- Minimize impacts on farm operations.
- Would not displace or disrupt agricultural land or terrestrial or aquatic ecosystems.

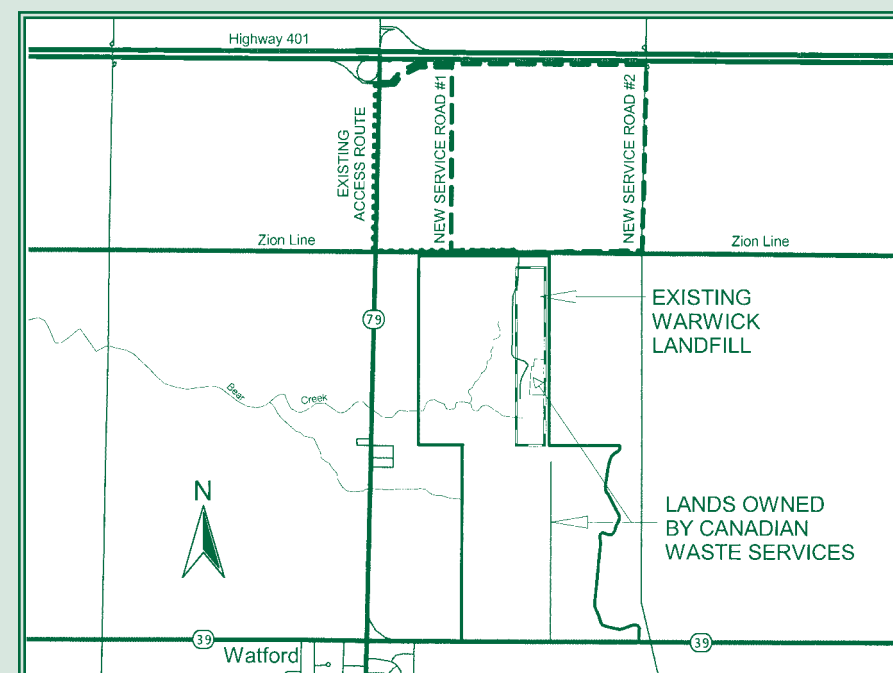

## DRAFT DISCUSSION PAPER #4 – IMPACT ASSESSMENT PROCESS

Draft Discussion Paper #4 – Impact Assessment Process - describes how the potential environmental impacts from the proposed landfill expansion will be assessed from the perspective of each discipline. The discussion paper provides information on the study areas and methods, including criteria, to be used by each discipline. The discussion paper also provides definitions of key terms so that the process and analyses can be more easily understood.

*Your views are requested on the criteria and approach described in this discussion paper.*

You may obtain a copy of Draft Discussion Paper #4: Impact Assessment Process at:

- The Township of Warwick Municipal Office
- The Watford Library
- The Warwick Landfill Office

Or call 1-800-555-3561 to have a copy sent to you.

Comments on Draft Discussion Paper #4 are to be provided to IER Planning, Research and Management Services by February 8, 2002

### The CWS Consulting Team

The members of the CWS consulting team will each assess the effects of the landfill expansion from the perspective of their respective disciplines:

Area of Expertise	Consultant	Area of Expertise	Consultant
Agricultural Impacts	ESG International	Landfill Design and Engineering	Henderson Paddon Environmental Inc.
Air Quality	RWDI Inc.	Landfill Gas Control Design	Comcor Environmental
Air Emissions and Health Assessment	Cantox Environmental Inc.	Natural Environment	Gartner Lee Limited
Archaeological and Heritage	Archaeological Services Inc.	Noise	Aercoustics Engineering Limited
Economics	PriceWaterhouse Coopers/Environmental Strategies Limited	Social Impact and Public Consultation	IER Planning, Research and Management Services
Hydrogeology and Geotechnical	Jagger Hims/Alston & Associates	Transportation	Cansult Limited
Land Use	Weston Consulting	Visual	Baker Turner Inc.

## CHANGES TO THE CONSULTATION PROGRAM

Through discussions among the Township of Warwick, the Peer Review Team, and CWS the consultation program has been amended. The specific changes are:

- A member of the Peer Review Team will attend all EASG meetings, and will be prepared to answer any questions on the peer review comments.
- CWS will prepare the final discussion paper, including a table of comments received and responses to them.
- Following Step 5, CWS will develop and maintain a list of 'outstanding issues' related to each discussion paper.

These amendments are described in the Addendum to Final Discussion Paper #1.

## SOCIAL IMPACT ASSESSMENT ACTIVITIES

The environmental assessment process includes a social impact assessment study, which is being conducted by IER Planning, Research and Management Services (IER). Social impact assessment is required to identify the changes that will likely result from a proposed development and to determine the significance of the changes and their effects on individuals, their quality of life and day-to-day activities, as well as on the operation of community facilities and features and the community as a whole. As part of this process, IER has recently been corresponding with residents of the community. Activities to date have included distribution of a mail-back survey to all households within the 1 km study area and to non-resident property owners. The survey included questions on residential and household characteristics, use of property and satisfaction with the community. In addition, interviews were held with community leaders and facility operators within the 3.5 km study area.

Invitations were also sent to all local residents within the 1 km study area to attend small group meetings, which were held in November 2001. The small group meetings included discussions on characteristics of the community, key issues in the community and concerns regarding the proposed landfill site expansion. The information from the surveys and small group meetings will be presented in future discussion papers and used in combination with other information for the assessment of potential social impacts from the proposed expansion. For additional information on the social impact assessment activities, please call the toll-free information line at 1-800-555-3561.